

Safa

JUNE 2023

RICE UNIVERSITY
HOUSTON, TEXAS

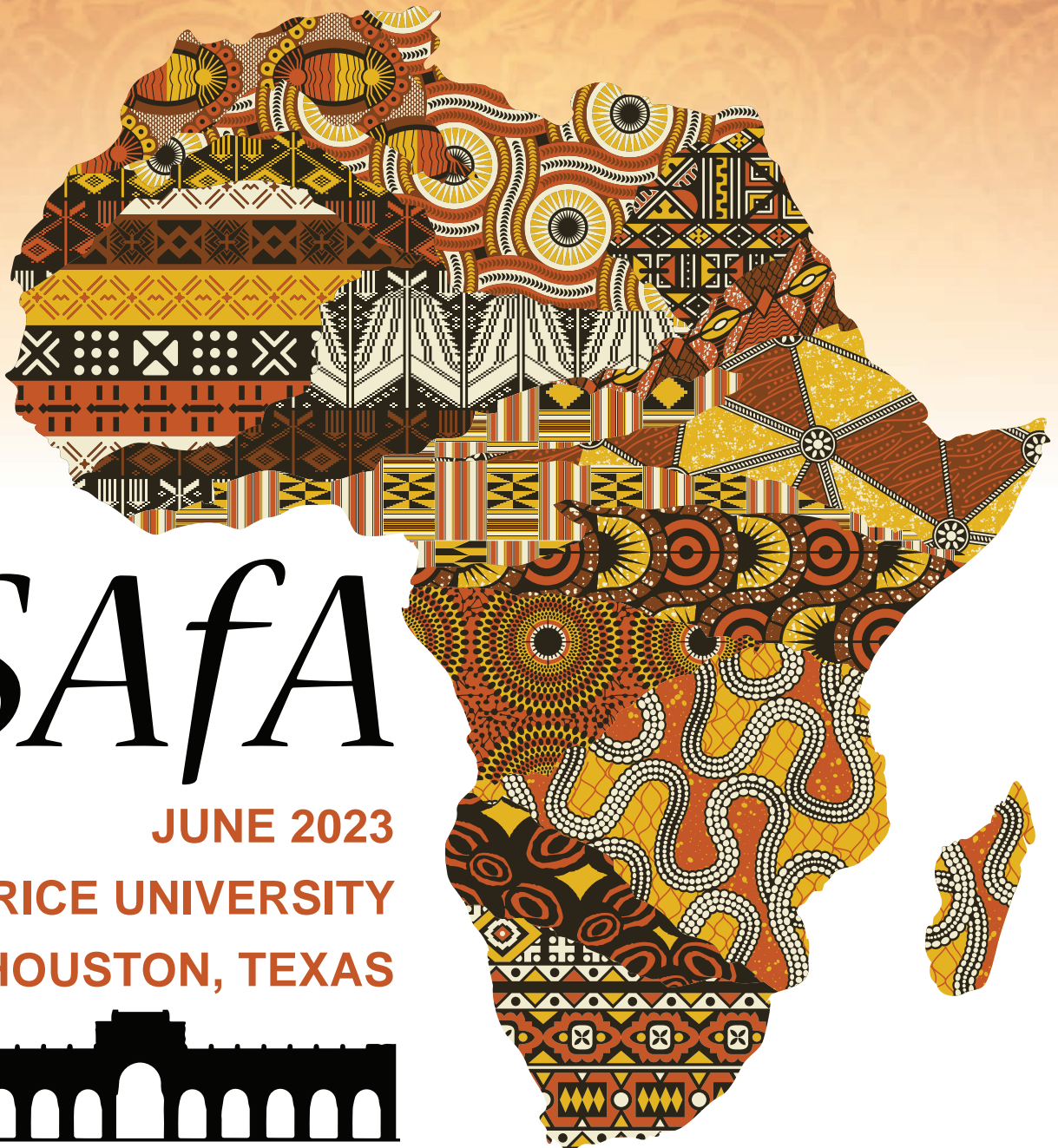

Maps

Anderson Clarke Center Floorplan

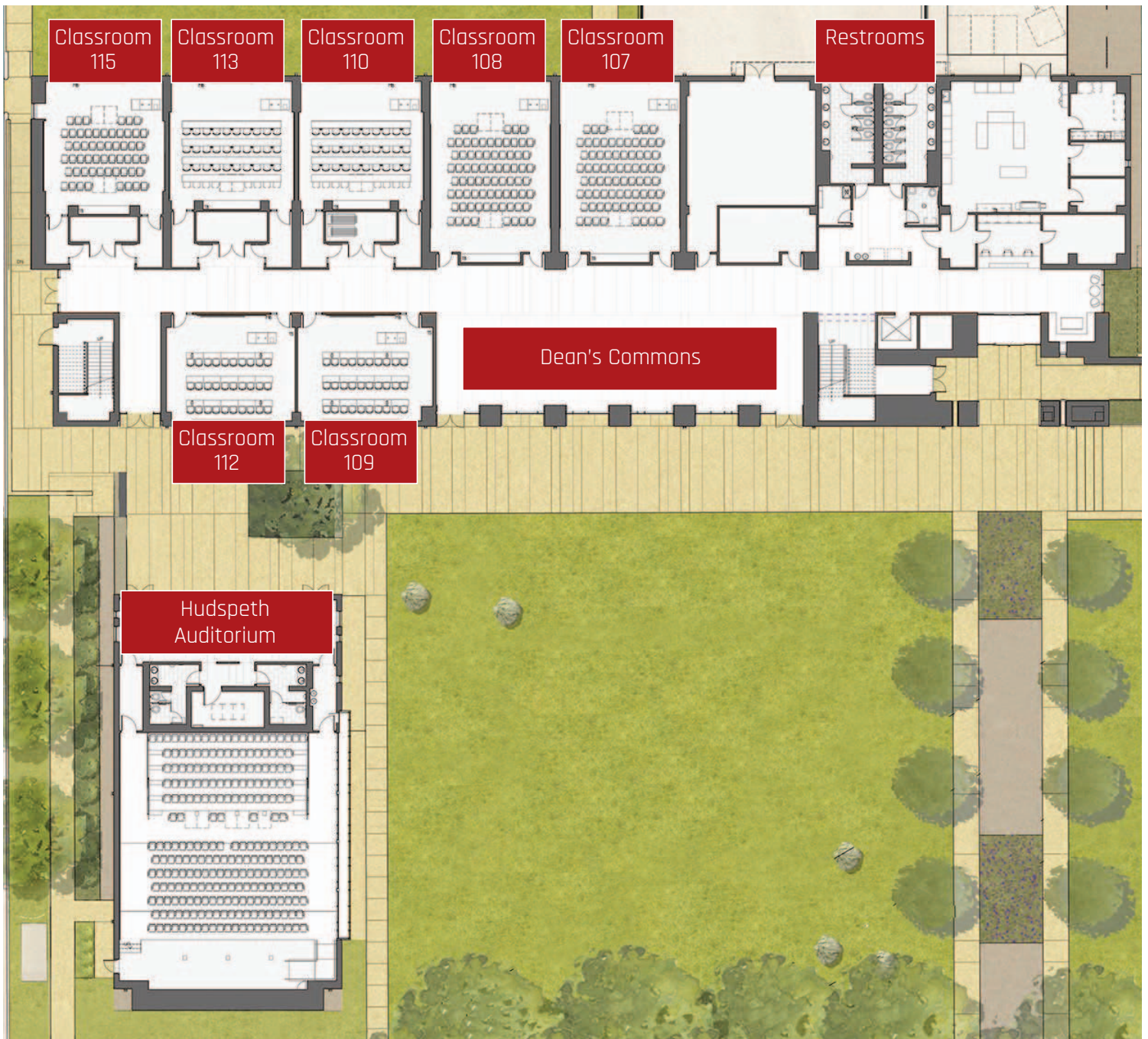

Support for SAFA2023 generously provided by:



RICE OFFICE OF RESEARCH
Creative Ventures Funds



Wenner-Gren
Foundation



RICE UNIVERSITY
Center for African and
African American Studies
School of Humanities • School of Social Sciences

Rice University Campus Map

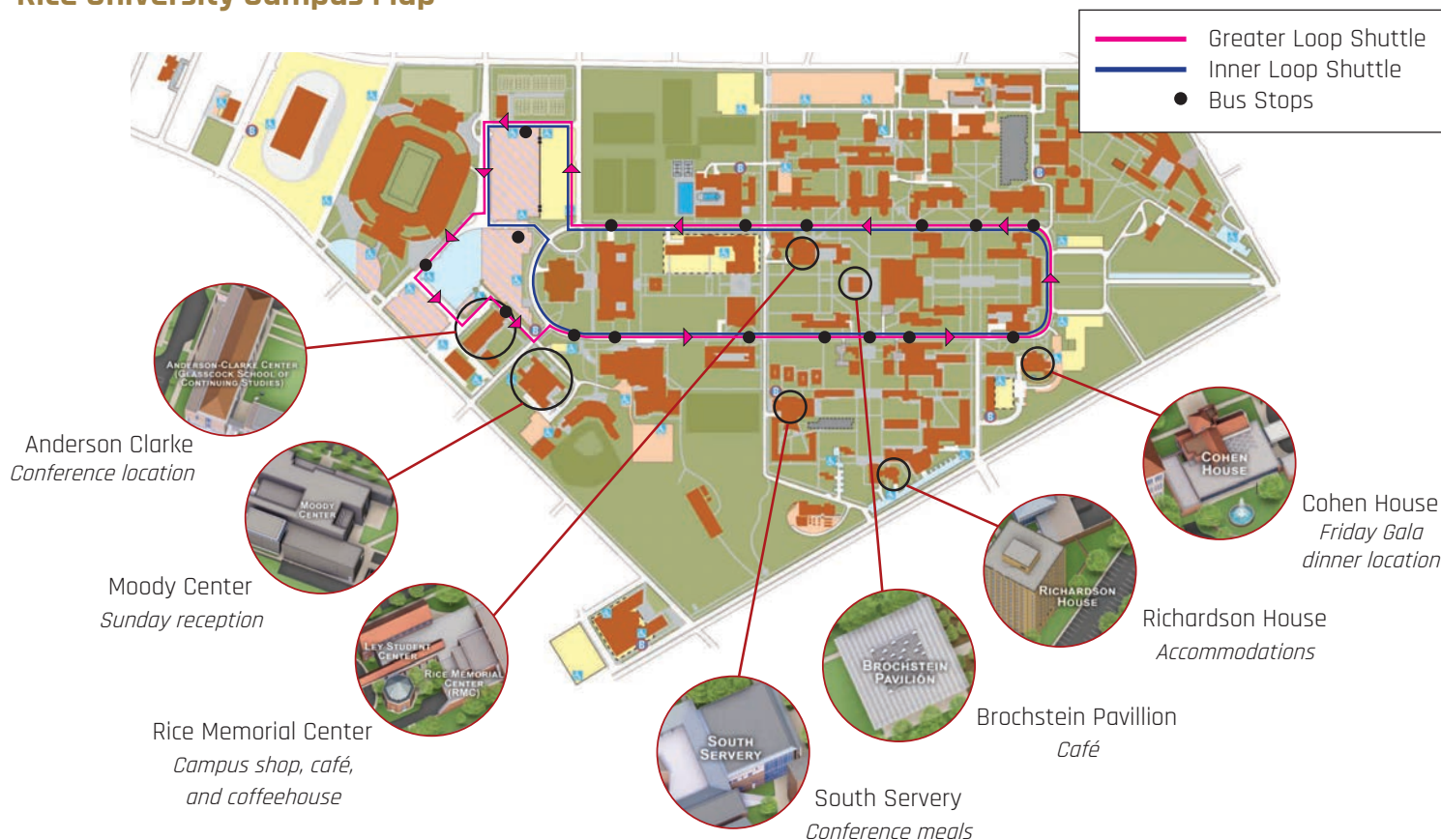

Useful Information



Register on Symposium



Connect to the conference:*

*You must be registered on Symposium use this link



General conference information

Accessing WiFi at Rice University: Use "Rice Visitor" network (no password required). If you have an Eduroam account, you may also use this network, but may find that Rice Visitor is faster.

Speaker information: If you are presenting in person, bring your presentation on a USB-compatible memory stick (flash drive) to the room where your session occurs, 30 minutes before the start of the session. You will meet with a technology assistant who will load your presentation on the room's computer.

Poster presenter information: Cork boards and pins will be available in the Dean's Commons of the Anderson Clarke Center (the conference venue). Poster presenters are responsible for ensuring their poster is hung on these boards prior to the start of the first poster session. Posters should remain up at least through the second poster session, and can remain up until the end of the conference. Posters left behind at the end of the conference will be disposed of.

Dining information: Breakfasts (7:30-10:30; included in accommodation), lunches (11:30-14:00; included in registration), and dinners (17:00-19:30; by prior purchase) are in the South Servery. Food can also be purchased at Brochstein Pavillion (Little Kitchen HTX; M-F 8:00-18:00, weekend 9:00-17:00) and Rice Memorial Center (Sammy's, M-F 11:00-14:00, Rice Coffeehouse, M-F 8:00-17:00). There are many restaurants in Rice Village, just to the west of campus. Please see the location map in this guide and the QR link to restaurants there.

Emergency telephone number in United States: 911

Rice University police: (+1) 713-348-6000

Houston metro (light rail and bus): <https://www.ridemetro.org/>

Rideshare services: Uber and Lyft are common in Houston and can be accessed via their apps

Contact info for conference planner: Ann Chai Dick, 713-553-0615

PROGRAM AT A GLANCE

The final detailed program can be downloaded here (.pdf):
<https://safarchaeology.org/safa-2023/programs>



Friday, June 2, 2023

| Time | Dean's Commons | Hudspeth Auditorium | Classroom 107 | Classroom 108 | Classroom 109 | Classroom 110 | Classroom 113 | Classroom 115 |
|-------------|----------------------------------------------------------------------------------------|---------------------|---------------------------------------------------------------|--------------------------------------------------------------------|---------------------------------------------------------------------------------------------------------|------------------------------------------------------------------------------|-----------------------------------------------------------------------------------------------------------------|--------------------------------------------------------------------------------------|
| 9:00-10:30 | | PLENARY SESSION | | | | | | |
| 10:30-11:00 | TEA & COFFEE BREAK | | | | | | | |
| 11:00-12:00 | | PLENARY SESSION | | | | | | |
| 12:00-13:30 | LUNCH BREAK | | | | | | | |
| 13:30-15:00 | | | 19. Integrative approaches to African archaeo-genetics | 8. Crafting new technologies: the archaeology of metallurgy | 6. Community archaeology and heritage management: monuments, museums, and collaborative projects | 25. Multi-disciplinary approaches to reconstructing past environments | 28. Pots, Bones, Seeds, Molecules: Early farming lifeways and subsistence patterns in sub-Saharan Africa | 31. Rethinking fuzzy boundaries and sharp borders in African material culture |
| 15:00-15:30 | TEA & COFFEE BREAK | | | | | | | |
| 15:30-17:00 | Poster Session | | 19. Integrative approaches to African archaeo-genetics | 8. Crafting new technologies: the archaeology of metallurgy | 6. Community archaeology and heritage management: monuments, museums, and collaborative projects | 25. Multi-disciplinary approaches to reconstructing past environments | 28. Pots, Bones, Seeds, Molecules: Early farming lifeways and subsistence patterns in sub-Saharan Africa | 31. Rethinking fuzzy boundaries and sharp borders in African material culture |
| 17:00-18:00 | | | | Remembering Nic David | | | | |
| 18:00-21:30 | Gala Opening Dinner Faculty Club At Cohen House (By Ticket Purchase Only) | | | | | | | |

* A screening will be held of the ethnographic film *Iron Technology as Ritual Performance: The Barongo of Western Tanzania*, organized by Prof. Peter Schmidt. Viewers are advised that one ritual performance incorporates unclothed bodies, an integral part of ritual reproductive power. A discussion will follow Saturday at 11 AM.

Plenary Speakers



Alemseged Beldados is Associate Professor of Archaeology in the Department of Archaeology and Tourism Studies, College of Social Sciences, Addis Ababa University. His research interests include human adaptation strategies in changing climatic conditions during the Pleistocene and Holocene epochs in Ethiopia and the Horn, Eastern Sudan and the Nile Valley. He is currently a Principal Investigator of the Addis Ababa University Archaeological Expedition to the Konso Zone, Southern Ethiopia.



Solange Macamo is Associate Professor in Archaeology and Built Heritage at the Department of Archaeology and Anthropology, Faculty of Arts and Social Sciences of UEM- Eduardo Mondlane University, Maputo- Mozambique. Her two current projects in Gaza Province, Mozambique are intended to integrate archaeological and biocultural heritage into a sustainable tourism to benefit coast communities. She was recently appointed the Director of CAIRIM (Centre for Archaeology, Research and Resources of the Island of Mozambique) and the Museum of Archaeology.



Ibrahima Thiaw is a Research Director of Archaeology at Institut Fondamental d'Afrique Noire (IFAN) at the University Cheikh Anta Diop of Dakar, Senegal. He has been respectively the curator of IFAN archaeological collections for more than 20 years and, of Museum Theodore Monod d'Art Africain ethnographic collections for nearly 10 years. He has worked throughout Africa, serving as a consultant for Environmental and Social Impact Assessment and conducting research on material culture, heritage management, community engagement, the politics of memory and identity and the long-term impacts of slavery and colonization in the making of the modern world.



Akin Ogundiran is Chancellor's Professor and Professor of Africana Studies, Anthropology & History at the University of North Carolina, Charlotte. He has served as editor-in-chief of the *African Archaeological Review* since 2019. Ogundiran's research interests broadly focus on the history and archaeology of the Yoruba world, Atlantic Africa, and the African Diaspora. He is a Member of the Nigerian Academy of Letters.



Joanne Clarke is Professor in the Department of Art History and World Art Studies at the University of East Anglia. She is an archaeologist with a background in people-climate relationships both in the past and in the present. In the last ten years she has developed a research profile in human-climate interactions through various research projects and outputs, including being a contributing author to the Africa Chapter of the Intergovernmental Panel on Climate Change, AR6 WGII.

Saturday, June 3, 2023

| Time | Classroom 107 | Classroom 108 | Classroom 109 | Classroom 110 | Classroom 113 | Classroom 115 | Classroom 112 |
|-------------|-----------------------------------------------------------------------------------------------------------------|-------------------------------------------------------------------------------------------|-----------------------------------------------------------------------|-----------------------------------------------------------------|----------------------------------------------------------------------------|---------------------------------------------------------------------------------------------------------------------------|--------------------------------------------------------------------|
| 8:30-10:30 | 14. From Pleistocene into the Holocene: Hunter-gatherers in southern Africa during the last 30,000 years | 17. Honoring Professor Susan McIntosh and her contributions to African archaeology | 16. Historical archaeology: from 1500 through the colonial era | 30. Reconstructing ancient African foodways | 24. Maritime archaeology and heritage in the southwest Indian Ocean | 7. Contemporary debates and challenges to museums, heritage, and archaeological knowledge production across Africa | 12. Environmental and Human-Environmental History in Africa |
| 10:30-11:00 | TEA & COFFEE BREAK | | | | | | |
| 11:00-13:00 | 14. From Pleistocene into the Holocene: Hunter-gatherers in southern Africa during the last 30,000 years | 17. Honoring Professor Susan McIntosh and her contributions to African archaeology | 16. Historical archaeology: from 1500 through the colonial era | RT 37: African Archaeology in Support of School Learning | 24. Maritime archaeology and heritage in the southwest Indian Ocean | | |
| 13:00-14:30 | LUNCH BREAK | | | | | | |
| 14:30-17:30 | Museum Excursions (Please sign up at registration, SPACE IS LIMITED FOR ALL MUSEUMS.) | | | | | | |



Houston Museum of Natural Science

This museum features an extensive paleontology exhibit, a small human origins exhibit, several galleries on terrestrial and marine life, two newly renovated archaeological and anthropological galleries on Egypt and the Americas, and extensive gem and mineral collections. There is also an interactive, child-friendly exhibit area focused on energy. This museum visit is self-guided.



Museum of Fine Arts, Houston

The collections of this encyclopedic art museum, spread across three buildings and a sculpture garden, include artwork from ancient times to the present, and from Europe, Africa, Asia and the Pacific, and the Americas. Exhibits of African heritage include the Glassell Collection of African Gold; ancient Egypt; and art of the Islamic world. This museum visit is self-guided.



Menil Collection

This landmark building designed by Renzo Piano houses the private collections of Dominique and John de Menil. These collections include emphasis on medieval and Byzantine art, modern and contemporary art (including extensive surrealist artworks), and extensive ancient art. The African art collection is particularly notable, and there is currently a temporary exhibit: *Art of the Cameroon Grassfields*. This museum visit will be guided by Dr. Paul Davis, curator of African art. No backpacks are allowed.

SAfA Artist's Installation

A focused installation of **Victor Ekpuk's** work will be on display at the Susanne M. Glasscock School of Continuing Studies in conjunction with the 26th biennial meeting of the Society of Africanist Archaeologists at Rice University. The installation will be comprised of three newly designed large-scale banners and two sculptures and will be on view from June 1st through June 30th, 2023.



Victor Ekpuk (b. 1964, Nigeria) is an internationally-renowned Nigerian-American artist based in Washington, D.C. In his paintings, drawings, and sculptures, he employs glyphs that are inspired by the aesthetics of indigenous African writing rituals, such as the ancient Nigerian communication system Nsibidi, as well as graphic symbols drawn from global contemporary culture. Over the last years, Ekpuk has increasingly focused on the connection between the past and present, exploring this relationship in large-scale murals, installations, and public art projects.



The artist explains that, "My work engages with a diverse spectrum of meaning, often mining historical narratives, the contemporary African diaspora, and humanity's connection to the sacred. I am very interested in anthropology, I want my works to be starting points for dialogue, new discoveries into the differences and commonalities among cultures. Whether I am mining writing systems or just exploring the juxtapositions between the ancient and the contemporary—these excavations are important to my work,"

Ekpuk has been included in various exhibitions, notably at the Princeton University Art Museum; The Tang Museum; Hood Museum; Fowler Museum; Museum of Art and Design; Newark Museum; Smithsonian National Museum of African Art; Institut du Monde Arabe, Paris; 12th Havana Biennial; Dakar Biennial; and the 1st Johannesburg Biennial, among others. His works are represented in numerous collections including the Smithsonian National Museum of African American History and Culture, and the Smithsonian National Museum of African Art, Washington D.C.; Museum of Fine Arts, Boston, MA; Kiran Nadar Museum of Art, New Delhi, India; Hood Museum, Hanover, NH; Krannert Art Museum, Champaign, IL; Newark Museum, NJ, and various others.

Organized by the Moody Center for the Arts with support from Creative Ventures Fund at Rice University.



RICE OFFICE OF RESEARCH
Creative Ventures Funds

Sunday, June 4, 2023

| Time | Dean's Commons | Classroom 107 | Classroom 108 | Classroom 109 | Classroom 110 | Classroom 113 | Classroom 115 |
|-------------|--------------------------------------------------------------|---------------------------------------------------------------------------------------------------------------|---------------------------------------------------|--------------------------------------------------------------------|---------------------------------------------------------------------------------------------|----------------------------------------------------------------------------------------------------------|-------------------------------------------------------------------------------------------------------------|
| 8:30-10:30 | | 20. Landscape and settlement: multidisciplinary approaches | 23. Linking Records of the African Past | 26. New insights on the Pleistocene of eastern Africa | 29. Recent research in the Middle Senegal Valley | 15. Global Processes through Local Lenses: Perspectives from the Atlantic and Indian Ocean Coasts | 10. Early villages and farming from the Cameroon Grassfields to Victoria Nyanza and the Eastern Cape |
| 10:30-11:00 | TEA & COFFEE BREAK | | | | | | |
| 11:00-12:00 | Poster Session | 20. Landscape and settlement: multidisciplinary approaches | 23. Linking Records of the African Past | 26. New insights on the Pleistocene of eastern Africa | 29. Recent research in the Middle Senegal Valley | | 10. Early villages and farming from the Cameroon Grassfields to Victoria Nyanza and the Eastern Cape |
| 12:00-13:30 | LUNCH BREAK | | | | | | |
| 13:30-15:00 | | 1. 25 Years Beyond Chiefdoms: Susan McIntosh's Pathways to Complexity Influence on African archaeology | 33. The archaeology of African pastoralism | 13. Ethnography, Indigenous Knowledge, and Material Culture | 21. Landscapes of Resistance: Archaeological Approaches and Comparative Perspectives | 11. Emerging Voices and Trends in West African Indigenous Archaeologies | 18. Human origins and Pleistocene archaeology |
| 15:00-15:30 | TEA & COFFEE BREAK | | | | | | |
| 15:30-17:00 | | 1. 25 Years Beyond Chiefdoms: Susan McIntosh's Pathways to Complexity Influence on African archaeology | 33. The archaeology of African pastoralism | | 21. Landscapes of Resistance: Archaeological Approaches and Comparative Perspectives | 11. Emerging Voices and Trends in West African Indigenous Archaeologies | 18. Human origins and Pleistocene archaeology |
| 17:00-18:00 | Dean's Commons: Artist's Presentation By Victor Ekpuk | | | | | | |
| 18:00-19:30 | Reception at Moody Center For The Arts | | | | | | |

Monday, June 5, 2023

| Time | Hudspeth Auditorium | Classroom 107 | Classroom 108 | Classroom 109 | Classroom 110 | Classroom 113 | Classroom 115 |
|-------------|---------------------|-------------------------------------------------------|-------------------------------------------------------------------------------------------------------|------------------------------------------------------------------------------------|---------------------------------------------------------------------------------|-------------------------------------------------------------|---------------------------------------------------|
| 8:00-10:00 | BUSINESS MEETING | | | | | | |
| 10:00-10:30 | TEA & COFFEE BREAK | | | | | | |
| 10:30-12:00 | | 2. Advances in African rock art studies | 27. Of Stones, Sherds, and Clay: The Archaeology of Built Urban Environments west of the Niger | 34. The archaeology of foraging in Pleistocene and Holocene southern Africa | RT 35: Visions of the past: teaching history as a tool of power | RT 36: Long-distance trade in Africa before 1500 CE | RT 40: Archaeology in African Universities |
| 12:00-13:30 | LUNCH BREAK | | | | | | |
| 13:30-15:00 | | 32. Technology and innovation in the Stone Age | 3. Archaeological investigations of cities and polities | 4. Archeology in Zambia: New and Ongoing Work | RT 39: Archaeological Sites & Monuments Registers and Planning Processes | 9. Digital tools and community archaeology in Africa | 5. Ceramics and craft production |
| 15:00-15:30 | TEA & COFFEE BREAK | | | | | | |
| 15:30-17:00 | | 32. Technology and innovation in the Stone Age | 3. Archaeological investigations of cities and polities | 4. Archeology in Zambia: New and Ongoing Work | 22. Life, Death, and Belief on the Nile | 9. Digital tools and community archaeology in Africa | 5. Ceramics and craft production |

Rice University Shuttles to Rice Village

Rice Village is a collection of shops, restaurants and pubs, situated about a half-mile west of the center of Rice University's campus. The core "Rice Village" extends over several city blocks, bounded by University Boulevard, Kirby Drive, Tangley Street, Morningside Drive, Rice Boulevard, and Greenbriar Drive. Use the QR link below to explore restaurant options.

Rice Village

The Rice Village Shuttle runs M-F 7:30 to 20:00 and NOT on Saturday and Sunday. Rice Village is a 20 minute walk from the conference location.

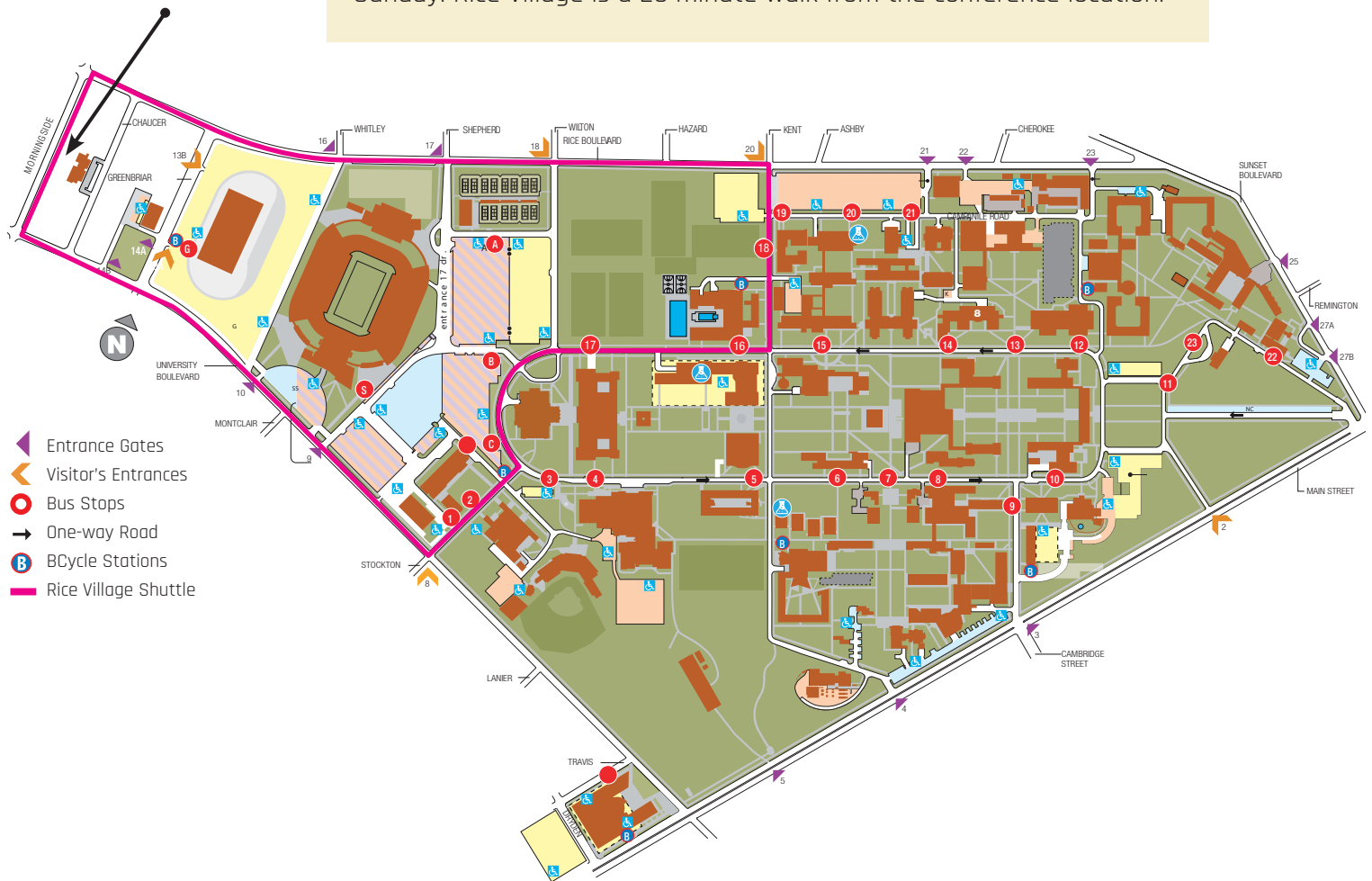

Please use this QR code to explore restaurant options in Rice Village.

CENTER FOR AFRICAN AND AFRICAN AMERICAN STUDIES



The Center for African and African American Studies is Rice's primary location for curriculum and research related to Africa and to people of African descent in the Americas and beyond. The center is a clearinghouse for critical conversation, instruction, cutting-edge research and community outreach in an interdisciplinary fashion.

A collaboration between the School of Humanities and the School of Social Sciences, the center produces synergies and harnesses collaborative engagement across the university. The center provides a unique hub for work on such crucial topics as: critical approaches to race and racism, the nature of diasporic histories and identities, and the complexity of Africa's past, present and future, to name a few.



caas.rice.edu @RiceCAAS

Journal of African Archaeology



BRILL

The Journal of African Archaeology is an international peer-reviewed periodical. It publishes original papers addressing recent research and developments in African archaeology and related disciplines. The journal's main purpose is to provide scholars and students with a pan-African forum for discussing relevant topics on the cultural dynamics of past African societies. Katherine Grillo, General Editor, kgrillo@ufl.edu.

AZANIA

Archaeological Research in Africa

A journal of the British Institute in Eastern Africa, *Azania: Archaeological Research in Africa* has, since its foundation in 1966, built up a strong track record in publishing papers on the archaeology and precolonial history of Eastern Africa. The journal now covers all aspects of African archaeology, regardless of temporal or spatial boundaries.

The journal seeks to become the premier outlet for publishing archaeological work on Africa's past. It publishes peer-reviewed papers and briefer research reports, as well as book and conference reviews.



A Journal of the British Institute in Eastern Africa

Routledge
Taylor & Francis Group

Editors:

- **Noemie Arazi** - Royal Museum for Central Africa, Belgium
noemie.arazi@africamuseum.be
- **Elisabeth Hildebrand** - Stony Brook University, USA
elisabeth.hildebrand@stonybrook.edu
- **Peter Mitchell** - University of Oxford, UK
peter.mitchell@st-hughs.ox.ac.uk

AFRICAN ARCHAEOLOGICAL REVIEW

welcomes delegates to the 26th Biennial Meeting of the Society of Africanist Archaeologists and congratulates Rice University as the conference host.

AAR is celebrating its 40th anniversary of publishing this year.

The journal publishes original research articles, review essays, reports, book/media reviews, and forums/commentaries on African archaeology, highlighting the contributions of the African continent to critical global issues in the past and present.

- 755 articles published since 1983.
- Thanks to the past Editors-in-Chief and their editorial staffs:
 - Nicholas David (1983-1986)
 - David Phillipson (1987-1994)
 - Fekri Hassan (1995-2008)
 - Adria LaViolette (2009-2018)
- Thanks to the Editorial Board Members for their invaluable service to the journal.
- Thanks to Cambridge University Press, Plenum Press, and Springer.
- Thanks to the Authors.
- Many thanks to the Reviewers.



Volume 40 Number 1
March 2023

African Archaeological Review



"The *African Archaeological Review* has, from its inception, made significant contributions to the professionalization of African archaeology, while remaining responsive to the interests of non-professionals through the promotion of articles aimed at public education, pedagogy, and heritage management policies."
--Cameron Gokee and Akin Ogundiran, AAR Editorial, 2023

